

ITEM NO.	DESCRIPTION	QTY.
1	SC OR SC/APC SIMPLEX ADAPTER	1
2	MOUNT CLIP (INSTALLED)	1
3	SNAP FIT ADAPTER	1
4	DUST CAP	2

CATALOG NUMBER	SNAP HOUSING COLOR	ADAPTER COLOR	SPLIT SLEEVE MATERIAL
SFSCYXX	'XX'	'YY'	PHOSPHOR BRONZE
SFSCYXX	'XX'	'YY'	ZIRCONIA
SFSCAXX	'XX'	GREEN	ZIRCONIA

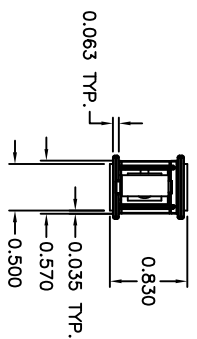
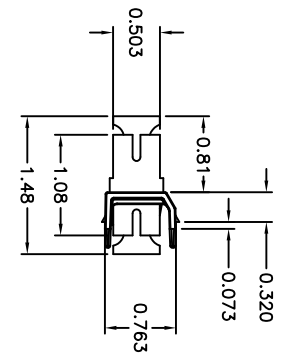
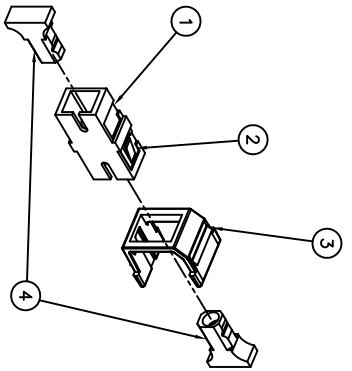
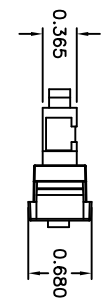

TO ORDER SNAP FIT ADAPTER
 REPLACE 'YY' WITH:
 REPLACE 'XX' WITH:

- | | |
|------------|---------------------|
| 'AQ' AQUA | 'AL' ALMOND |
| 'BE' BEIGE | 'BK' BLACK |
| 'BK' BLACK | 'G' GRAY |
| 'GN' GREEN | 'EJ' ELECTRIC IVORY |
| 'R' RED | 'LA' LIGHT ALMOND |
| 'Y' YELLOW | 'DW' OFFICE WHITE |
| 'B' BLUE | 'W' WHITE |

- NOTES
 UNLESS OTHERWISE SPECIFIED:
 1. SOLD IN CARTON INCREMENTS ONLY. CARTON CONTAINS 25 MODULES (INDIVIDUALLY BAGGED).
 2. SPECIFICATIONS SUBJECT TO CHANGE WITHOUT NOTICE.
 3. SPLIT SLEEVE MATERIAL - SEE TABLE ZIRCONIA COMPATIBLE WITH BOTH SINGLEMODE AND MULTIMODE FIBER. PHOSPHOR BRONZE COMPATIBLE WITH MULTIMODE FIBER ONLY.

REV. J		19525		01/08/15		UPDATED CATALOG NUMBER MATRIX FOR BLUE ADAPTERS		MMA		CHG BY		APPD BY			
ECN		DATE		DESCRIPTION		MMA		CHG BY		APPD BY					
Created on AUTOCAD															
DIMENSIONING AND TOLERANCE PER ANSI Y14.5M-1992 UNLESS OTHERWISE SPECIFIED, DIMENSIONS ARE IN INCHES (MM). TOLERANCES: XX = ±0.1 (±2.5) XXX = ±0.025 (±0.635) ANGLE TOL. 1/2° IN ACCEPTING OUR DRAWINGS, BLUEPRINTS, OR SUPPORTING DOCUMENTATION FOR QUOTATION OR OTHER PURPOSES, YOU AGREE NOT TO DISCLOSE AND OTHERS THE DESIGN AND OTHER DESIGNS SHOWN HEREIN, AND THAT YOU WILL MAKE NO USE OF SAME WITHOUT PERMISSION.															
PROJECT REFERENCE:				DRAWN BY: P.S. MAGUIRE 05/30/2001				CHECKED BY: H. MCGREGOR 06/11/01				APPROVED BY: G. KIENSTED 06/11/01			
MATERIAL:				TITLE: SNAP FIT (SF) MODULES				HUBBELL				Hubbell Premise Wiring HUBBELL INCORPORATED (Delaware) 14 Lovell's Hill Road, Stoughton, Connecticut 06378			
SIZE: C		SCALE: FULL		DRAWING NO: C11410		SHEET: 1 OF 1		REV. J							