



## Model 1040-AP325 Cloud or Canopy Ceiling WAP Installation Kit-AP325

Category: Suspended Ceiling Mounts



Model 1040 is an economical, easy-to-install cloud or canopy mounting kit for WAPs from most vendors. A cutout is made in the ceiling panel, the panel bridge is placed above the ceiling panel, and the white trim is placed around the WAP. The WAP is attached to a universal mounting T-bar and pressed into the panel bridge. The WAP is now recessed into the ceiling much like a recessed light fixture for unobstructed wireless coverage. WAP trim can be swapped out for alternate WAP brands.

*Patent pending*

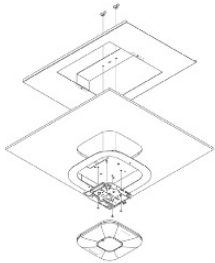

### Features & Benefits

- Conveniently and quickly install wireless access points in cloud or canopy ceiling panels
- Access point mounts flush to the ceiling, providing an aesthetic, professionally installed appearance
- 20 ga. galvanized steel panel bridge and adjustable hanger wire prevent ceiling panel sag or cracking

### Technical Specifications

- Design: Recessed installation kit for installing wireless access points in cloud, canopy, or suspended ceiling panels. Comprised of steel ceiling panel bridge, adjustable hanger wire, access point bracket, and trim for Aruba AP325.
- Performance: UL Listed for low-voltage applications and designed to meet NEC300-22 and 300-23 for plenum installations.
- Access point trim is interchangeable for other access points
- Construction: 20 ga. galvanized steel panel bridge, white, powder-coated steel trim
- Use hanger wire to attach to building structure
- Size: 16 inches by 23.75 inches by 3 inches (406 mm by 603 mm by 76mm)

### Standards for Safety

- UL 2416, Audio/Video, Information and Communication Technology Equipment Cabinet, Enclosure & Rack Systems
- CSA C22.2 NO. 60950-1-07 + Amd. 1 Amd. 2 Information Technology Equipment -- Safety. Part 1, General Requirements

# Configurations

AP-specific trim is included with the product; please specify the trim required.

Note: The trim is interchangeable after installation. Please contact your Oberon representative for additional trim options.

Model Number	Description	Retrofit trim P/N
1040-AP205	Small trim for Aruba Networks AP205	37-4X-AP205
1040-AP215	Small trim for Aruba Networks AP215	37-4X-AP215
1040-AP225	Small trim for Aruba Networks AP225	37-4X-AP225
<b>1040-AP325</b>	Small trim for Aruba Networks AP325	37-4X-AP325
1040-CCOAP	Small trim for Cisco Enterprise APs	37-4X-CCOAP
1040-CCOAP3800	Small trim for Cisco 2800, 3800 APs	37-4X-CCOAP3800
1040-HLA	Small trim for Cisco AP with hyperlocation antenna	37-4X-HLA

## Measurements *(Maximum values):*

- Height: 18 in.
- Width: 23.75 in.
- Depth: 3 in.
- Item Weight: 4 lbs.
- Shipping Weight: N/A

## Includes

- (1) 18" x 23.75" galvanized steel ceiling panel bridge
- (1) AP-specific, white powder-coated trim (see Configurations)
- (1) T-bar bracket or mounting bracket
- Adjustable hanger wire
- Installation instructions

## Documentation Links

 [Spec Sheet](http://oberoninc.com/index.php?option=com_content&view=article&id=2387&Itemid=399) - oberoninc.com/index.php?option=com\_content&view=article&id=2387&Itemid=399

 [Installation Instructions](http://oberoninc.com/images/WebDocs/Model1040-AN_Installation_Instructions.pdf) - oberoninc.com/images/WebDocs/Model1040-AN\_Installation\_Instructions.pdf

 [Customer Prints](http://oberoninc.com/images/WebDocs/Model1040_XX_CustomerPrint.pdf) - oberoninc.com/images/WebDocs/Model1040\_XX\_CustomerPrint.pdf

 [SECTION 27\\_21\\_33 DATA COMMUNICATIONS WIRELESS ACCESS POINTS -](http://oberoninc.com/images/WebDocs/SECTION_27_21_33_DATA_COMMUNICATIONS_WIRELESS_ACCESS_POINTS.pdf)

[http://oberoninc.com/images/WebDocs/SECTION 27\\_21\\_33 DATA COMMUNICATIONS WIRELESS ACCESS POINTS.pdf](http://oberoninc.com/images/WebDocs/SECTION_27_21_33_DATA_COMMUNICATIONS_WIRELESS_ACCESS_POINTS.pdf)

*Images and documents may depict similar models in the product series.*

## Dimensional Images

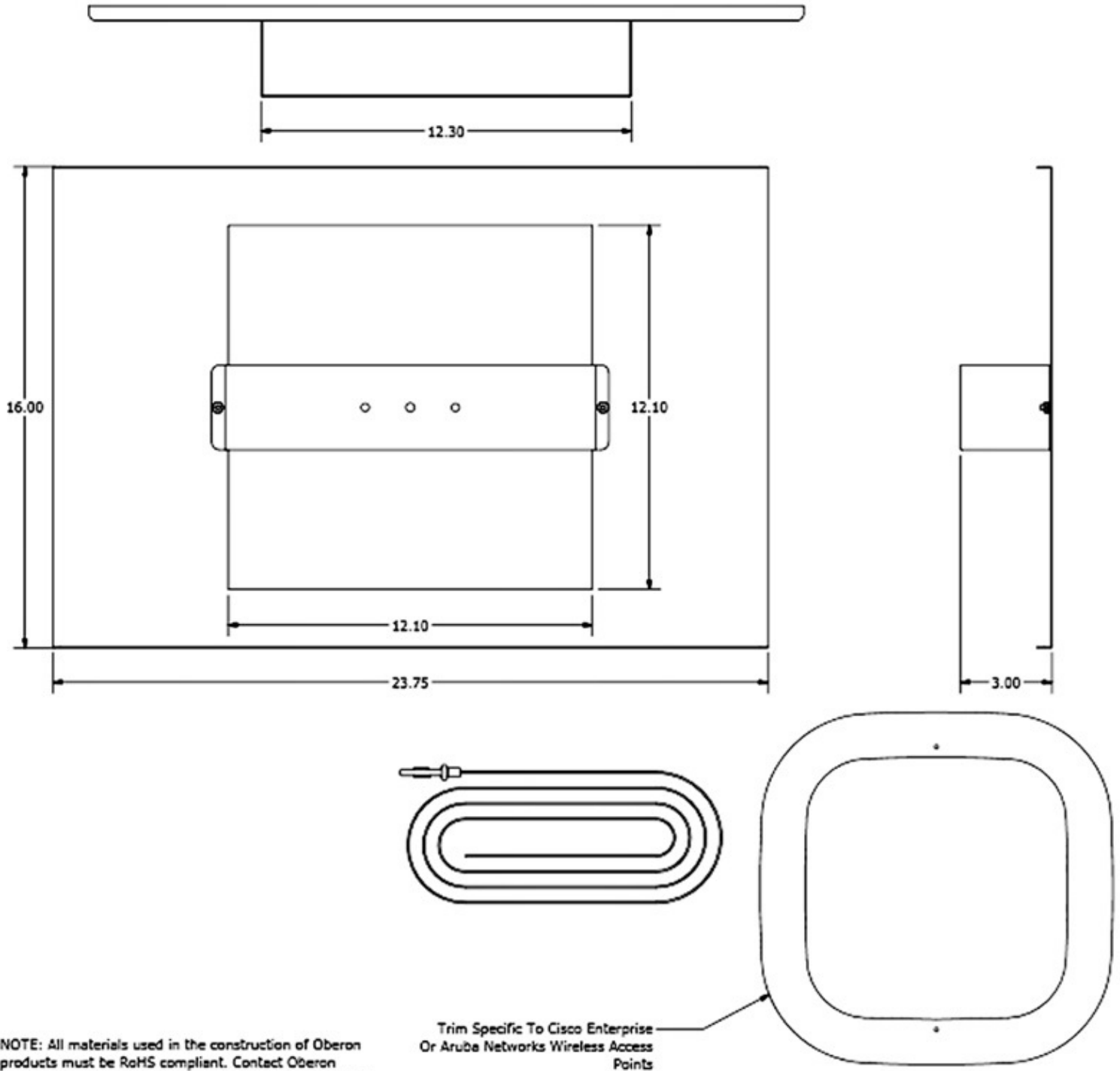

NOTE: All materials used in the construction of Oberon products must be RoHS compliant. Contact Oberon engineering if RoHS compliant materials are not available.